

Ref.1

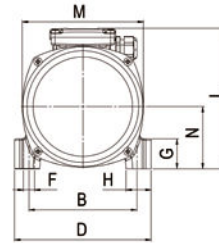

Ref.2

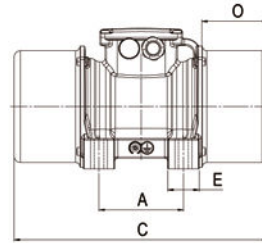
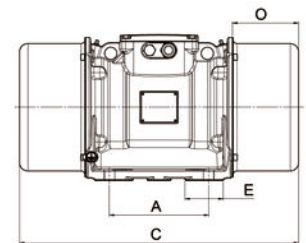

8 poli trifase 750/900 giri – 8 poles three-phase 750/900 rpm

Descrizione – Description					Caratteristiche Meccaniche – Mechanical Specifications						Caratteristiche Elettriche – Electrical Specifications			
Codice Code	Tipo Type	Grandezza Size	 II 2 D Temp. Class		Momento Statico Static Moment		Forza Centrifuga Centrifugal Force				Potenza assorbita Max Max. Input Power		Corrente Max (A) Max. Input Current (A)	
					kgmm		kg		kN		(W)		400V 50Hz	460V 60Hz
					50Hz	60Hz	50Hz	60Hz	50Hz	60Hz	50Hz	60Hz		
V8019	VV20B/8	DA	130°C	•	167	167	113	163	1,11	1,60	210	230	0,80	0,71
V8023	VV30B/8	EA	130°C	•	298	298	189	271	1,85	2,66	330	360	1,00	1,00
V8024	VV35B/8	GA	120°C	•	446	446	281	400	2,76	4,1	360	400	0,80	0,78
V8025	VV38B/8	HA	120°C	•	714	714	450	650	4,41	6,38	370	420	1,10	1,10
V8026	VV40B/8	IA	120°C	•	982	982	619	894	6,07	8,77	370	470	1,30	1,20
V8027	VV50B/8	LA	150°C	•	1518	1518	956	1381	9,38	13,5	900	1000	2,10	2,10
V8028	VV53B/8	LA	135°C	•	1937	1937	1220	1762	12,0	17,3	1050	1250	2,50	2,50
V8006	VV55B/8	MA	135°C	•	2321	2321	1462	2112	14,3	20,7	1400	1700	3,60	3,70
V8007	VV60B/8	NA	135°C	•	3482	3482	2194	3167	21,5	31,1	1900	2200	5,10	5,00
V8016	VV62B/8	NA	135°C	•	4285	4285	2700	3900	26,5	38,3	2400	2800	5,80	5,80
V8008	VV65B/8	OA	135°C	•	4732	4732	2981	4306	29,2	42,2	2700	3200	6,20	6,20
V8009	VV67B/8	OA	135°C	•	5714	5714	3600	5200	35,3	51,0	3800	4100	7,70	7,40
V8010	VV71B/8	PA	135°C	▲	7232	7232	4556	6581	44,7	64,6	4700	5500	9,40	9,00
V8029	VV74B/8	QA	135°C	▲	7381	7381	4650	6720	45,6	65,9	5500	5900	10,3	9,80
V8011	VV81B/8	QA	135°C	▲	12700	10990	8000	10000	78,5	98,1	6400	7000	12,5	11,3
V8013	VV141B/8	SA	-	▲	18254	15385	11500	14000	113	137	8700	9100	19,9	18,5
V8014	VV171B/8	SA	-	▲	21430	19010	13500	17300	132	170	9800	10500	20,8	18,9
V8015	VV221B/8	TA	-	▲	28890	24725	18200	22500	179	221	11800	15900	25,1	27,2
V8030	VV261B/8	TA	-	▲	-	28890	-	26300	-	258	-	15900	-	27,2

▲ Certificazione CSA disponibile su richiesta, con cavo di alimentazione incluso / CSA certification on request, power supply cable included

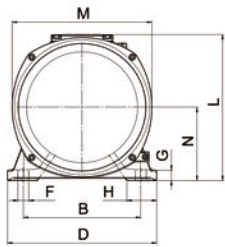

Ref.3

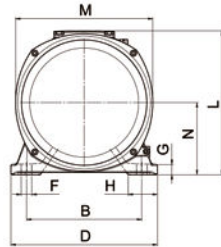
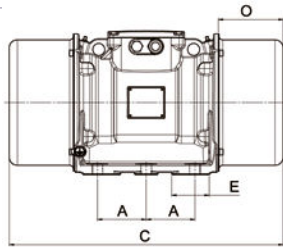

Ref.4

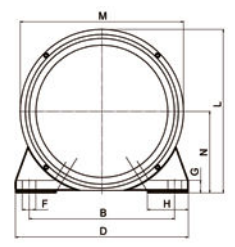
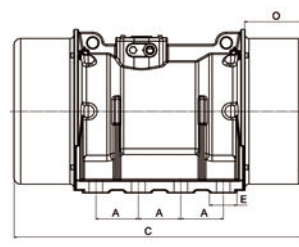

Dimensioni (mm) – Dimensional Specifications (mm)

Peso Weight (kg.)		Ref.	Distanze di Fissaggio Fixing distances					Fori Fissaggio Fixing holes		G	H	L	M	N	O	Pressacavo Cable gland	Cod. Code
50Hz	60Hz		A	B	C	D	E	ØF	N°								
18,1	18,1	1	105	140	340	167	38	13	4	30	31	203	160	82,5	91	M25x1,5	V8019
26,2	26,2	1	120	170	382	205	47	17	4	45	37,5	211	182	93,5	100	M25x1,5	V8023
32,6	32,6	1	120	170	436	205	42	17	4	42	40	224	203	104,5	118	M25x1,5	V8024
44,0	44,0	1	140	190	490	230	50	17	4	45	45	244	225	116	129	M25x1,5	V8025
54,0	54,0	1	140	190	560	230	50	17	4	45	45	244	225	116	164	M25x1,5	V8026
80,0	80,0	1	155	225	601	275	55	22	4	70	55	272	253	130	169	M25x1,5	V8027
92,0	92,0	1	155	225	655	275	55	22	4	70	55	272	253	130	196	M25x1,5	V8028
109	109	2	155	255	657	315	81	23,5	4	27	63	321	295	157	173,5	M25x1,5	V8006
188,0	188,0	2	180	280	730	345	99	26	4	28	77,5	346	320	165	200	M32x1,5	V8007
204,0	204,0	2	180	280	790	345	99	26	4	28	77,5	346	320	165	230	M32x1,5	V8016
238,0	238,0	2	200	320	735	380	106	28	4	28	80	364	356	183	187,5	M32x1,5	V8008
268,0	268,0	2	200	320	826	380	106	28	4	28	80	364	356	183	233	M32x1,5	V8009
315,0	315,0	2	200	320	854	390	106	28	4	30	95	392	378	192	247	M32x1,5	V8010
328,0	328,0	2	125	380	862	460	76	39	6	35	107,5	431	414	215	230	M32x1,5	V8029
438,0	419,0	3	125	380	1002	460	76	39	6	35	107,5	431	414	215	300	M32x1,5	V8011
702,0	680,0	4	140	480	1040	570	90	45	8	41	135	537	538	268	240	M32x1,5	V8013
755,0	711,0	4	140	480	1120	570	90	45	8	41	135	537	538	268	280	M32x1,5	V8014
934,0	894,0	4	140	520	1115	610	90	45	8	45	145	612	594	297	280	M32x1,5	V8015
-	934,0	4	140	520	1115	610	90	45	8	45	145	612	594	297	280	M32x1,5	V8030